

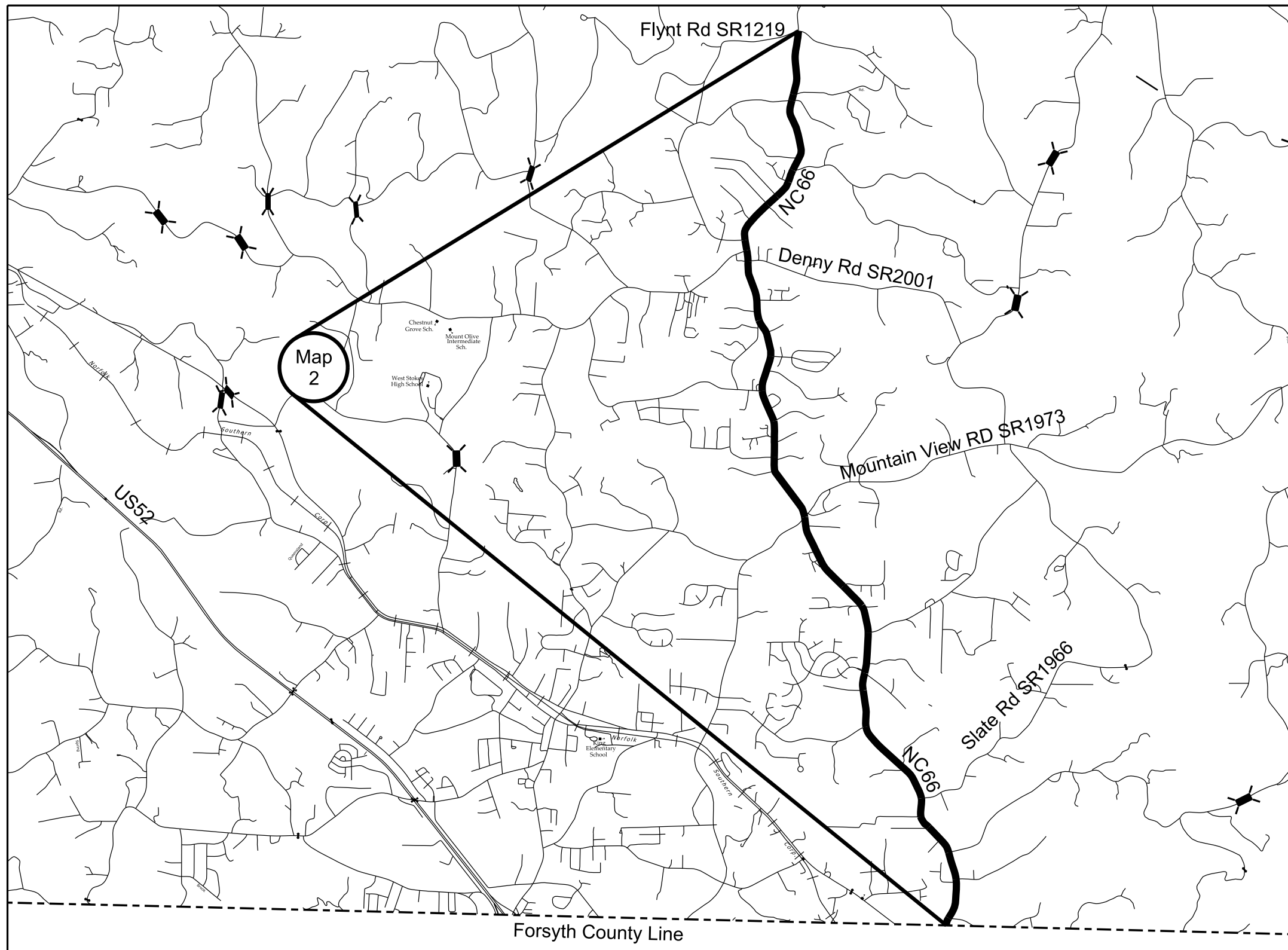



- Map 1 NC8 From Rosebud Rd SR1945 to NC89
Mill 1 1/2" entire width
Mill 1 1/2" incidental mill at all SR y-lines
Pave 1 1/2" S9.5B
- Map 5 Hawkins Rd SR1973 from Mountain View Rd/ N Freindship Rd SR1955 to FlatShoals Rd SR2019
Mill 0-1 1/2" incidental mill at beginning, end and at all SR intersections
Pave 1 1/2" S9.5B
- Map 6 Mountain Rd SR2018 from NC8 to Flat Shoals Rd SR2019
Mill 0-1 1/2" incidental mill at beginning, end and all SR intersections
Pave 1 1/2" S9.5B



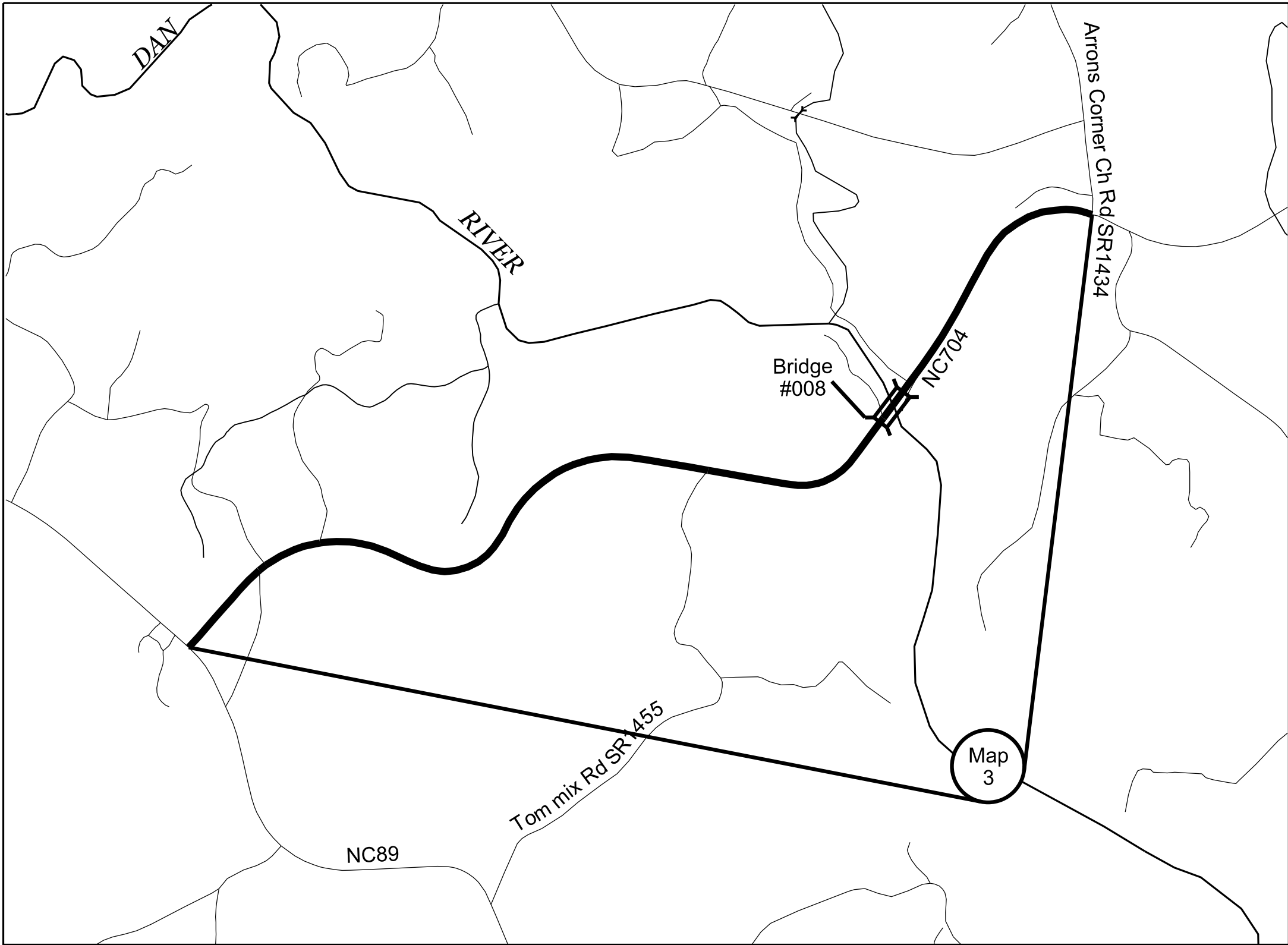

 Map 2 NC66 from Forsyth county line to Flynt Rd SR1219
 Mill 0-1 1/2" incidental mill beginning, end and at SR intersections
 Pave 1 1/2" S9.5B

PROJECT REFERENCE NO.	SHEET NO.
2022CPT.09.09.10851 2022CPT.09.10.20851	3



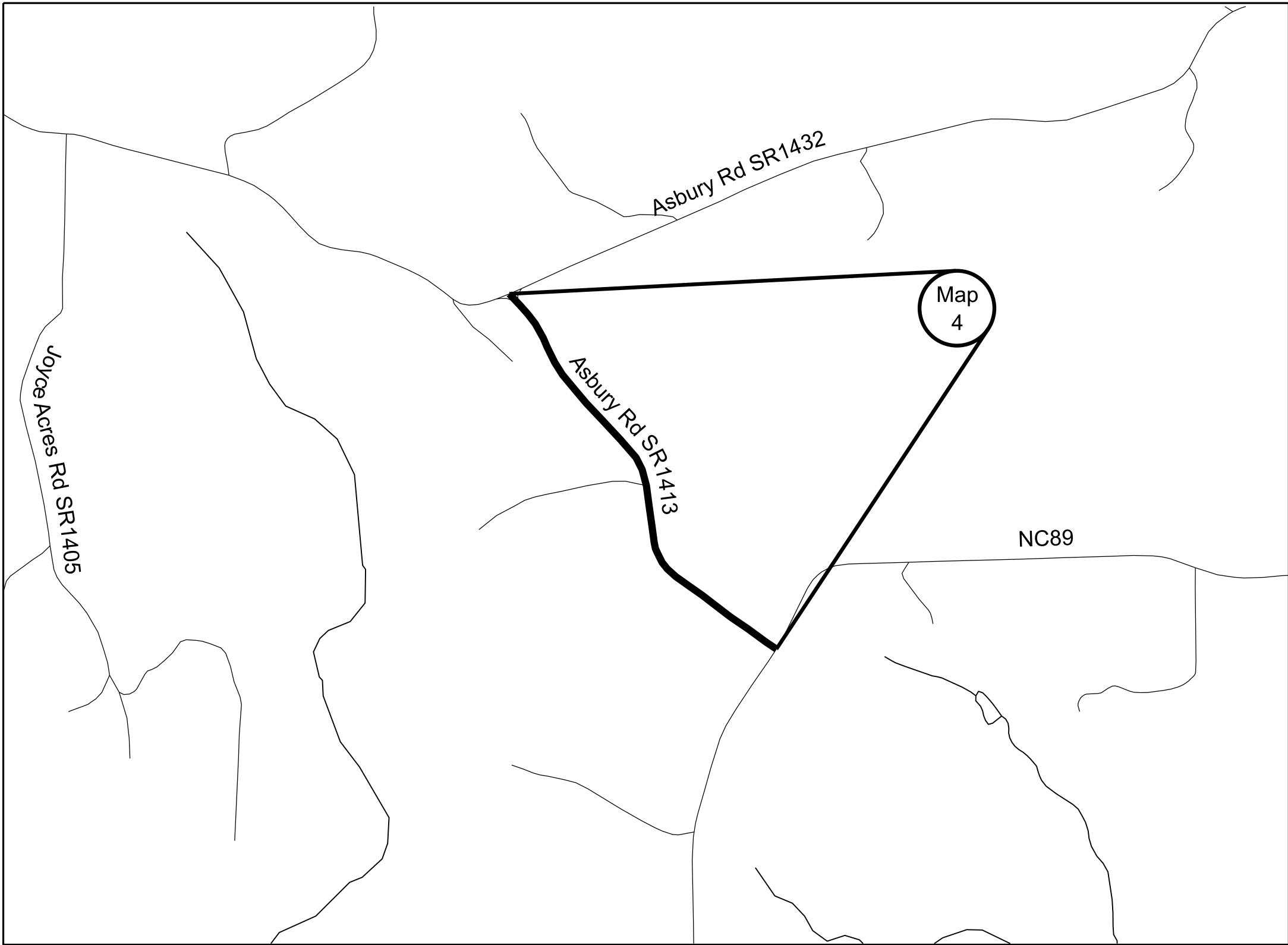

 Map 3 NC704 from NC89 to Arrons
 Corner Church Rd SR1434
 Mill 0-1 1/2" incidental mill beginning,
 end, all SR intersections and new
 Pvt. construction joints at Bridge
 #008
 Pave 1 1/2" S9.5B

PROJECT REFERENCE NO.	SHEET NO.
2022CPT.09.09.10851 2022CPT.09.10.20851	4

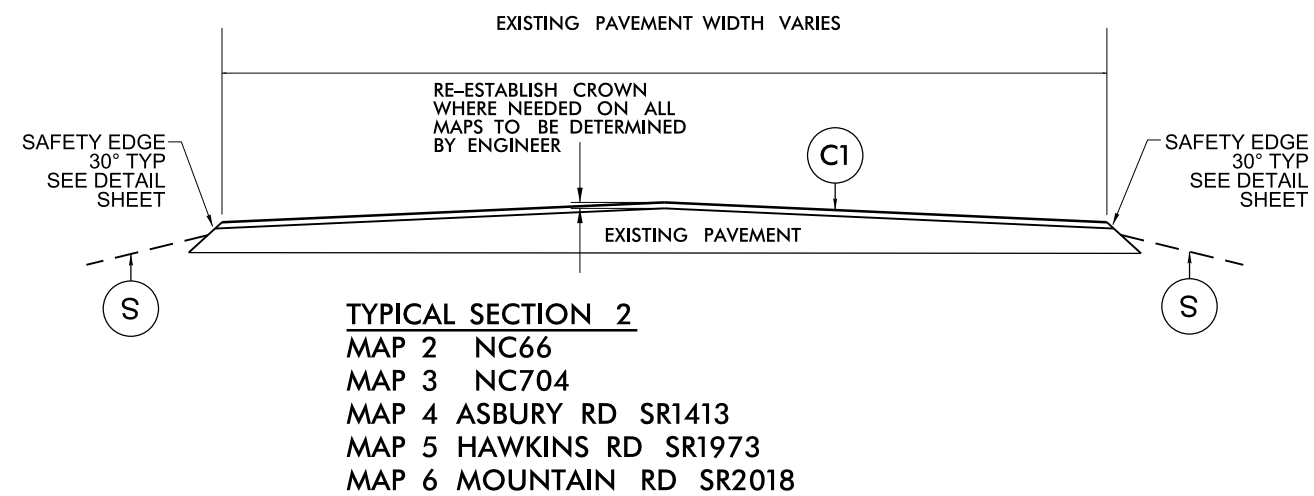
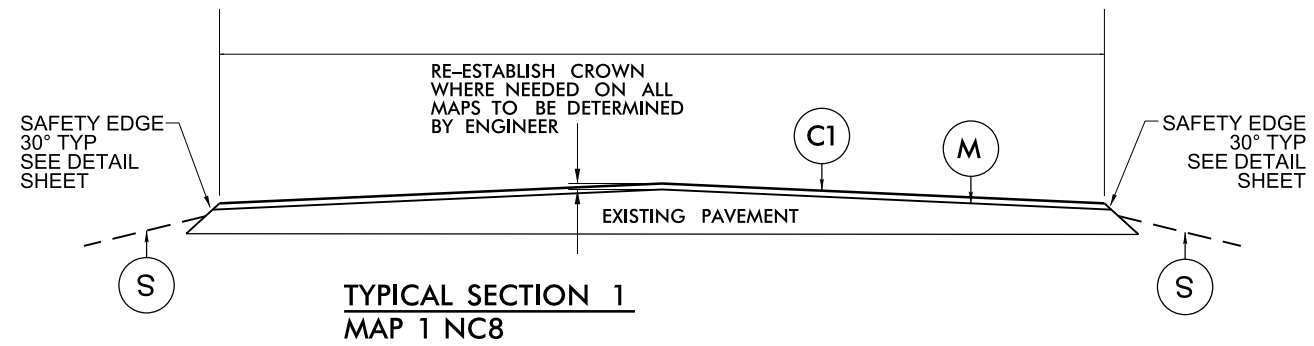

Map 4 Asbury Rd SR1413 from
Asbury Rd SR1432 to NC89
Mill incidental 0-11/2" at beginning,
end and all SR intersections
Pave 11/2" S9.5B

STOKES COUNTY
NORTH CAROLINA



PAVEMENT SCHEDULE	
C1	PROP. APPROX. 1½" ASPHALT CONCRETE SURFACE COURSE, TYPE S9.5B, TO BE APPLIED AT AN AVERAGE RATE OF 165 LBS PER SQ YD.
M	MILL ASPHALT PAVEMENT, 1½" DEPTH ENTIRE WIDTH
S	SHOULDER RECONSTRUCTION (SEE DETAIL)

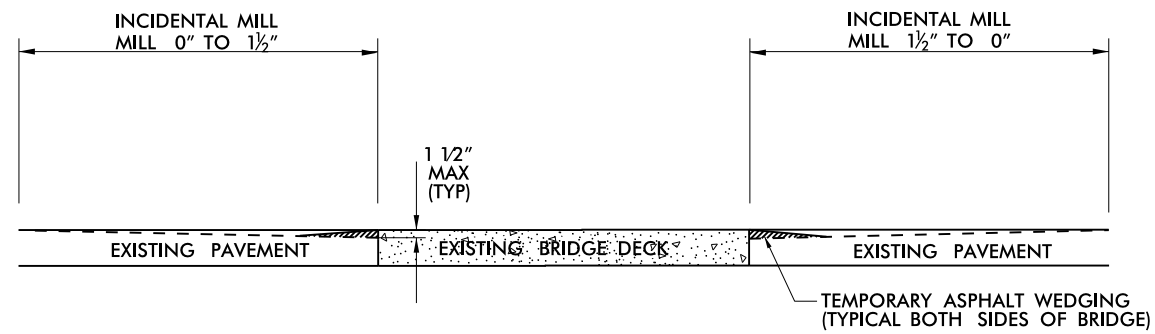

**INCIDENTAL MILLING
BRIDGE APPROACHES**
(SEE BRIDGE DATA SHEET)

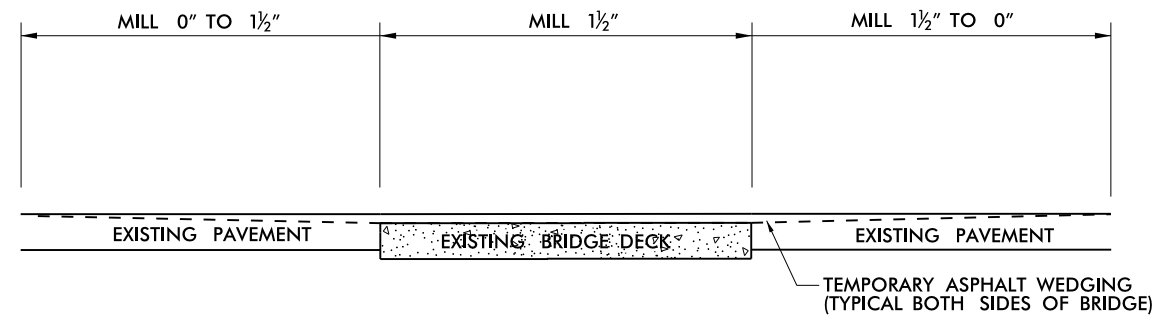

**INCIDENTAL MILLING
BRIDGE APPROACHES**
(SEE BRIDGE DATA SHEET)

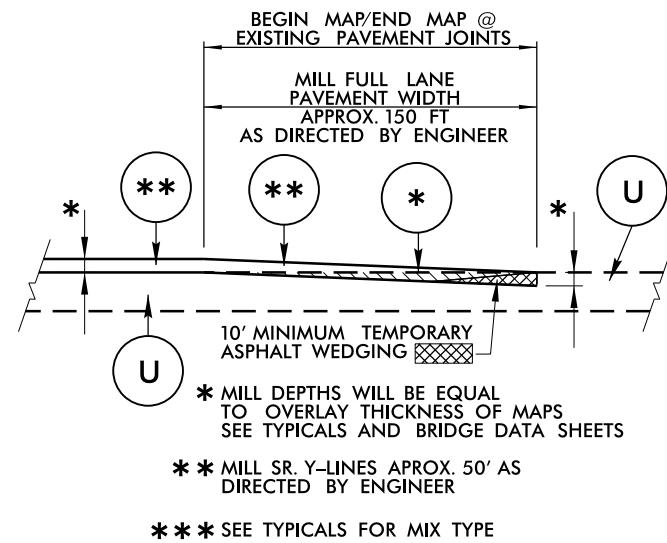

INCIDENTAL TIE-IN MILLING DETAIL

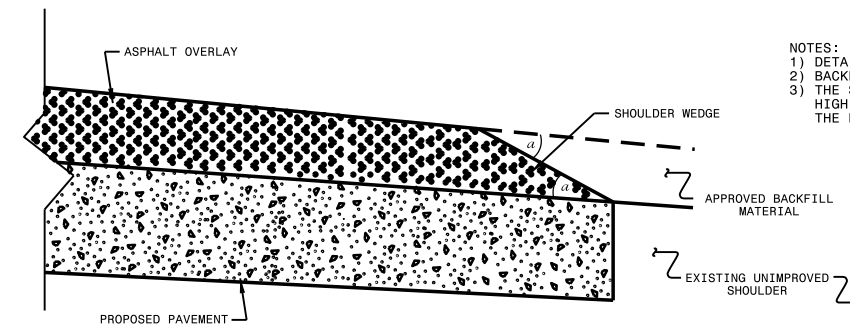

SHOULDER WEDGE DETAIL
(Resurfacing Projects w/ Widening or
with Existing Paved Shoulder having no dropoffs)

- NOTES:
 1) DETAIL DOES NOT APPLY TO OGAFK AND ULTRA-THIN BONDED WEARING COURSE.
 2) BACKFILL SHOULDER WITH APPROVED MATERIAL.
 3) THE SHOULDER WEDGE DEVICE MAY BE DISENGAGED AT PAVED DRIVEWAYS AND SIDE STREETS, HIGH SHOULDERS, AND OTHER LOCATIONS NOT FEASIBLE TO CONSTRUCT AS DIRECTED BY THE ENGINEER.

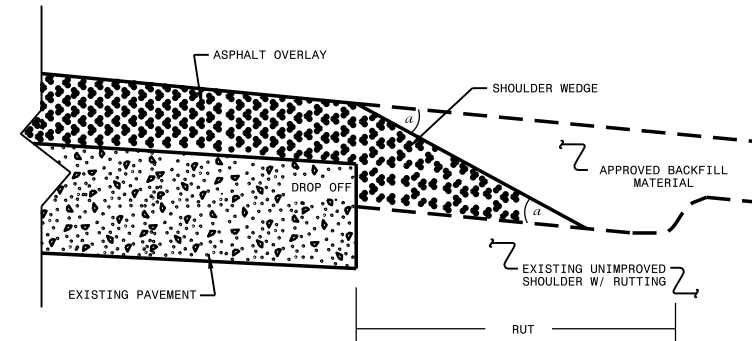

SHOULDER WEDGE DETAIL
(Resurfacing Adjacent to
Rutted Shoulder)

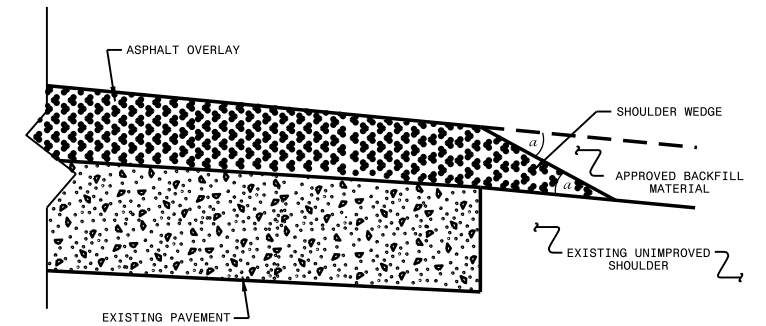

SHOULDER WEDGE DETAIL
(Resurfacing Projects w/ NO Widening)

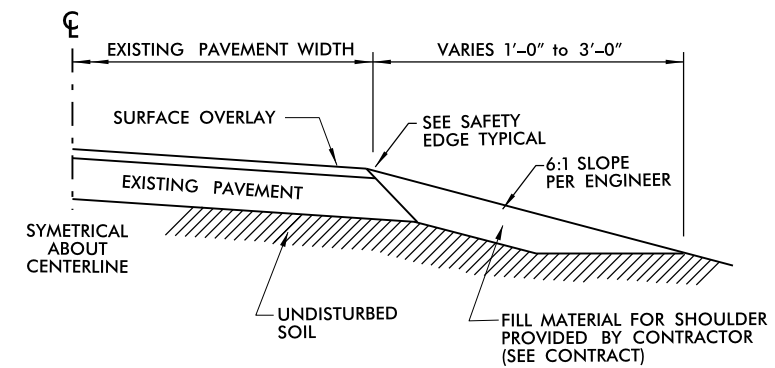

SHOULDER RECONSTRUCTION

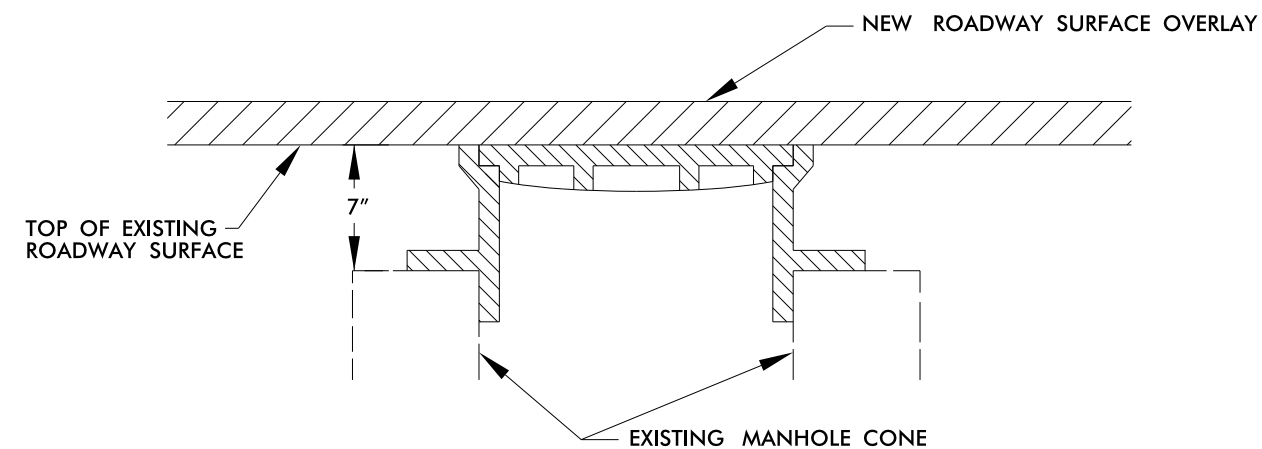
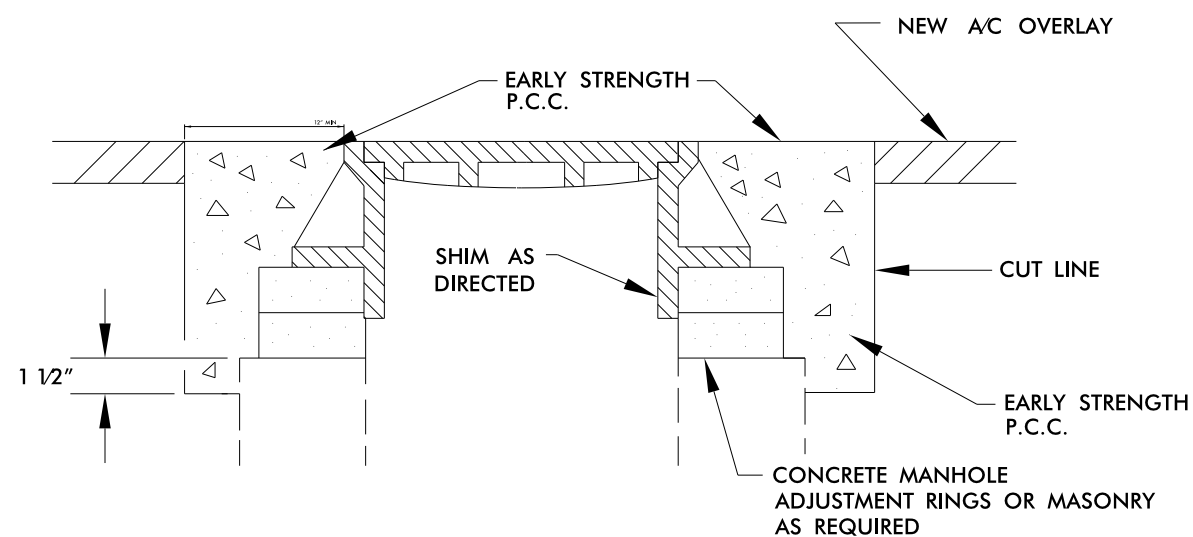
**STEP 1****STEPS 2,3, & 4**

- STEP 1 COVER EXISTING MANHOLE WITH APPROVED MATERIAL AND CONSTRUCT OVERLAY ACROSS TOP OF MANHOLE
- STEP 2 SAW CUT EXCAVATION AROUND MANHOLE 12" MIN. FROM MANHOLE FRAME.
- STEP 3 RAISE MANHOLE FRAME RINGS TO FINISH PAVEMENT PROFILE AND CROSS SLOPE.
- STEP 4 BACKFILL WITH EARLY STRENGTH P.C.C. TO DEPTHS AS DIRECTED.

MANHOLE ADJUSTMENT DETAIL**CONSTRUCTION NOTES:**

- ALL QUANTITIES ARE "ESTIMATED" AS INDICATED IN THE "SUMMARY OF QUANTITIES".
- CONSTRUCTION SHALL PROGRESS IN PHASES, IN THE ORDER INDICATED BELOW:
 - PHASE 1 - MILLING AND PATCHING (WHEN REQUIRED)
 - PHASE 2 - SURFACE OVERLAY
 - PHASE 3 - SHOULDER DROP-OFF REPAIR (AS NEEDED AND DIRECTED BY ENGINEER)
 - PHASE 4 - UTILITY ADJUSTMENTS (MANHOLE RING/COVER, VALVE/METER BOX RING/COVER, CATCH BASIN GRATE/COVER, DROP INLET GRATE/COVER, ETC.) WHEN REQUIRED.
- BRIDGES THAT HAVE FLOOR DRAINS, SHALL HAVE ALL FLOOR DRAINS LEFT OPEN. EXTRA CARE SHALL BE EXERCISED IN MILLING (IF REQUIRED) AND IN PLACING THE WEARING SURFACE AROUND FLOOR DRAINS SO AS NOT TO HINDER EFFECTIVE DRAINAGE.
- TEMPORARY ASPHALT WEDGING SHALL BE PLACED ON THE SAME DAY THAT BRIDGE AND/OR RAILROAD APPROACHES ARE MILLED (AND IF APPROACHES ARE MILLED PRIOR TO BRIDGE DECK).
- FOR TWO-LANE ROADWAYS - IT SHALL BE UNDERSTOOD THAT TYPICALLY ON A ROADWAY MEASURING 20 FEET OR LESS IN WIDTH, THE CENTER OF THE WHITE EDGELINE SHALL BE LOCATED SIX INCHES FROM THE EDGE OF PAVEMENT ON EITHER SIDE OF THE ROADWAY; ON A ROADWAY MEASURING 22 FEET IN WIDTH, TRAVEL LANES SHALL MEASURE 10 FEET AND THE WHITE EDGELINE SHALL BE LOCATED ONE FOOT FROM THE EDGE OF PAVEMENT ON EITHER SIDE; ON A ROADWAY MEASURING 24 FEET IN WIDTH, TRAVEL LANES SHALL MEASURE 11 FEET AND THE WHITE EDGELINE SHALL BE LOCATED ONE FOOT FROM THE EDGE OF PAVEMENT ON EITHER SIDE; ON A ROADWAY MEASURING 26 FEET OR MORE IN WIDTH, TRAVEL LANES SHALL MEASURE 12 FEET AND THE WHITE EDGELINE SHALL BE LOCATED NO LESS THAN ONE FOOT FROM THE EDGE OF PAVEMENT ON EITHER SIDE. THIS SHALL BE STANDARD PRACTICE UNLESS OTHERWISE DIRECTED BY THE ENGINEER.
- PAPER JOINTS ARE TO BE PLACED BETWEEN DAYS OF PAVING OPERATIONS AS SPECIFIED IN THE STANDARD SPECIFICATIONS SECTION 610-11.
- ALL MILLED AREAS WILL BE PAVED WITHIN 72 HOURS UNLESS APPROVED BY THE ENGINEER.
- REPLACE ANY PORTION OF STOP BARS AND OTHER PAVEMENT MARKINGS AT ANY INTERSECTION INCLUDING Y-LINES NOT ACTUALLY BEING PAVED OVER, THAT ARE OBLITERATED BY THE PAVING OPERATION EITHER BY HAULING WHEEL TRACKS OR TACK TRUCK BY THE END OF EACH RESURFACING OPERATION

NOTES: Less than 5' - 10' undisturbed buffer from ROW, ditchline, water feature, or drainage inlet, add BMP.

BMP Options: Wattle or Silt Fence

EROSION CONTROL DETAIL

PROJECT REFERENCE NO.	SHEET NO.
2022CPT.09.09.10851 2022CPT.09.10.20851	8

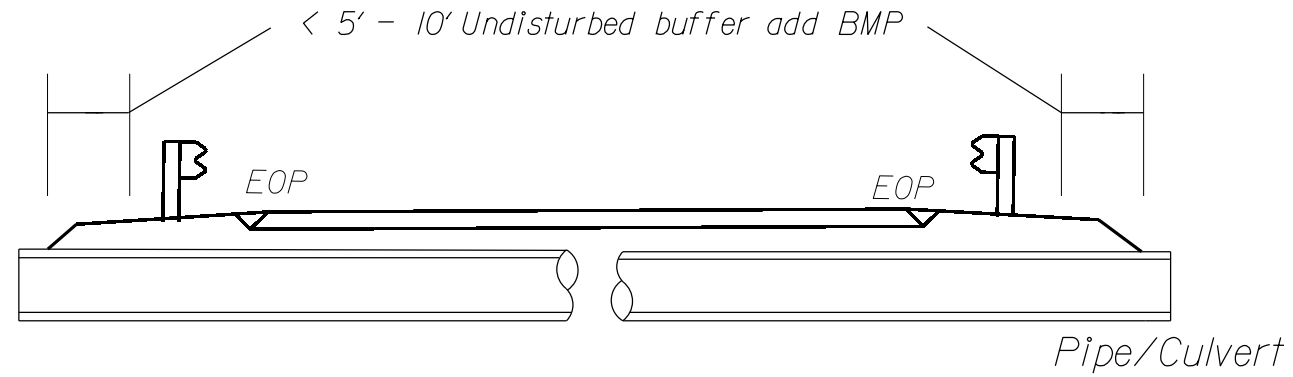

< 5' - 10' Undisturbed buffer from jurisdictional feature add BMP

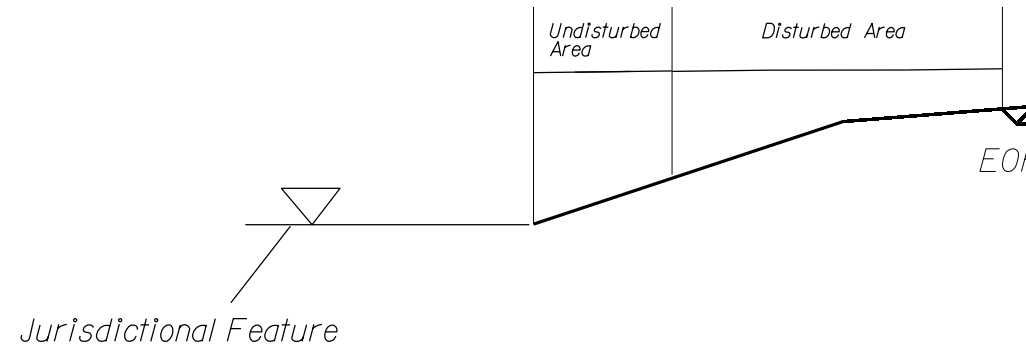

< 5' - 10' Undisturbed buffer from ditchline, add BMP



Use BMP's if shoulders and/or frontslopes and/or ditchline and/or backslopes are disturbed

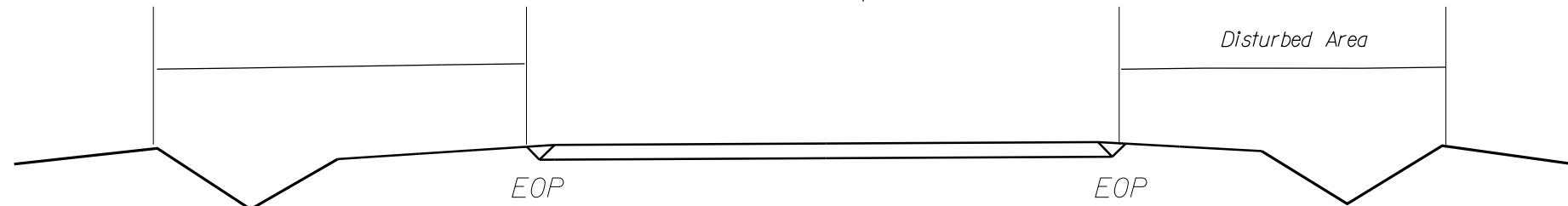

< 5' - 10' Undisturbed buffer from inlet, add wattle

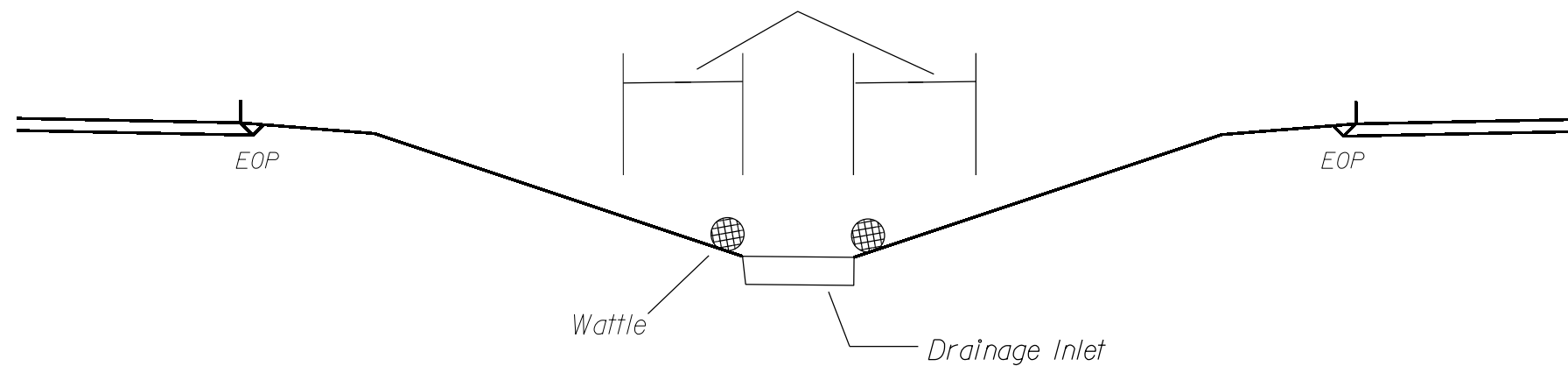

NOT TO SCALE

SIGNING FOR RESURFACING PROJECTS

LEGEND

┆ STATIONARY SIGN

← DIRECTION OF TRAFFIC FLOW

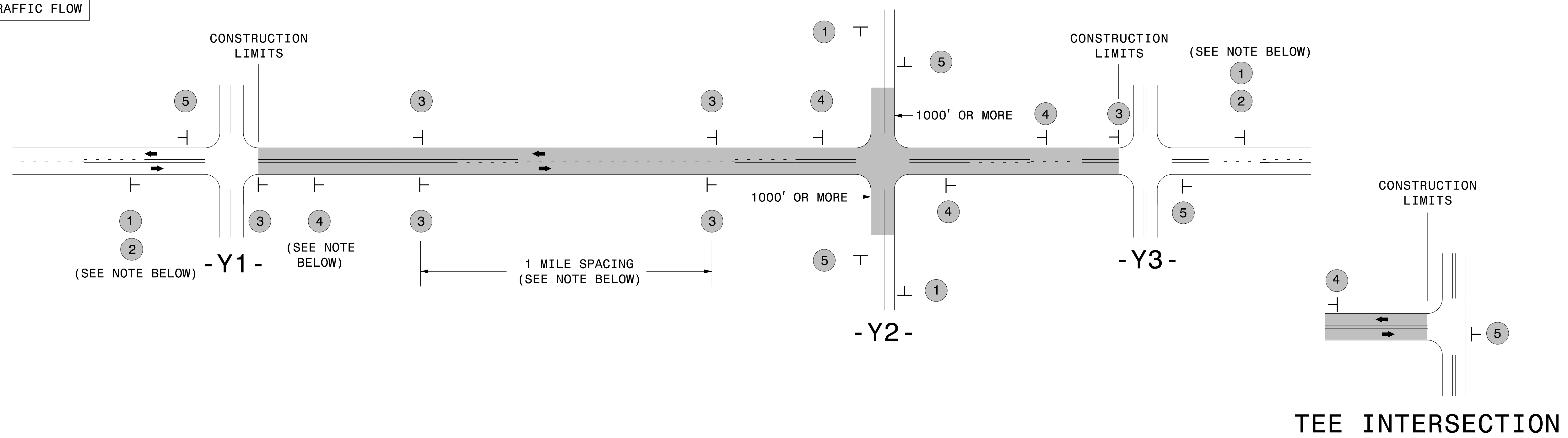

SIGNING NOTES AND PLACEMENT PER DIRECTION	1		PLACE 1000' PRIOR TO BEGINNING OF CONSTRUCTION LIMITS. ONLY USED ON -Y- LINES IF RESURFACING LIMITS EXTEND 1000' ALONG -Y- LINE.	<p>NO REQUIRED STATIONARY SIGNING FOR THE FOLLOWING -Y- LINE CONDITIONS:</p> <ol style="list-style-type: none"> LESS THAN 1000' OF RESURFACING ALONG -Y- LINE SUBDIVISION ROADS DEAD END ROADS <p>WHEN PAVING/CONSTRUCTION ACTIVITIES PROCEED ACROSS AN UNSIGNED -Y- LINE, PORTABLE ADVANCE WARNING SIGNS SHALL BE USED ALONG THE -Y- LINE AS SHOWN BELOW. REMOVE UPON COMPLETION OF WORK.</p> <div style="display: flex; justify-content: space-around;"> <div style="text-align: center;"> W20-1 48" X 48" PLACED 500' IN ADVANCE OF FLAGGER. </div> <div style="text-align: center;"> W20-7 A 48" X 48" PLACED 250' IN ADVANCE OF FLAGGER. </div> </div>
	2		#2 SIGN ONLY USED WHEN CONSTRUCTION LIMITS ARE 2 OR MORE MILES IN LENGTH. ROUND UP TO NEXT WHOLE NUMBER. (NO FRACTIONAL OR DECIMAL NUMBERS)	
	3		- PLACE INITIALLY AT THE CONSTRUCTION LIMITS AND SPACE 1 MILE APART THEREAFTER. - AT TEE INTERSECTIONS INSTALL INITIALLY 1/2 MILE FROM INTERSECTION AND SPACE 1 MILE APART THEREAFTER.	
	4		- THESE ARE FOR -Y- LINES THAT ARE "THROUGH" ROADWAYS. - DEAD END AND SUBDIVISION ROADS ARE NOT "THROUGH" ROADWAYS. - INSTALL 500' +/- FROM EACH -Y- LINE APPROACH AS SHOWN ABOVE. - FOR MULTIPLE -Y- LINES THAT ARE SEPARATED BY 0.25 MILES OR LESS, TREAT AS A SINGLE UNIT AND INSTALL WITHIN 500' OF EACH APPROACH. - A MAXIMUM OF 2 SIGN SETS PER MILE. DO NOT INSTALL WHEN -Y- LINES ARE WITHIN 0.5 MILES FROM "END ROAD WORK" SIGN. - FOR TEE INTERSECTIONS, INSTALL WITHIN 500' +/- OF THE INTERSECTION ALONG -L- LINE.	
	5		PLACE 500' FOLLOWING THE END OF CONSTRUCTION LIMITS OR AS SHOWN WHEN WORK ENDS AT A 3-WAY TEE INTERSECTION.	

THE ABOVE SIGNS ARE ALL THAT ARE REQUIRED FOR A CONTRACTOR TO BEGIN A RESURFACING CONTRACT. ANY ADDITIONAL SIGNS REQUESTED BY NCDOT DIVISIONS SHALL BE INSTALLED WITHIN 7 BUSINESS DAYS OF THE START OF CONTRACT WORK.

MAPS LESS THAN 2 MILES

FOR RESURFACING MAPS WITH CONSTRUCTION LIMITS LESS THAN 2 MILES IN LENGTH, NO STATIONARY SIGNS ARE REQUIRED. USE PORTABLE "ROAD UNDER CONSTRUCTION" OR "ROAD WORK AHEAD" SIGNS IN LIEU OF STATIONARY ADVANCE WARNINGS SIGNS.

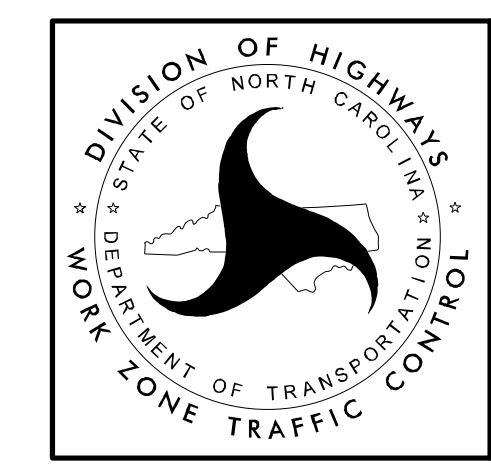

ADVANCE WARNING SIGNS FOR RURAL AND SUBURBAN 2-LANE ROADWAY RESURFACING

5/15/2017 S:\TUX\WZTC\Resurfacing\2L2W & AST Resurfacing Details\Resurfacing_AdvWarn_2Ln.dgn User:kadai

PROJECT NO.	SHEET NO.	TOTAL NO.
2022CPT.09.09.10851	10	
2022CPT.09.10.20851		

SUMMARY OF QUANTITIES

PROJECT NO	COUNTY	MAP NO	ROUTE	DESCRIPTION	TYP NO	LANES	LANE TYPE	FINAL SURFACE TESTING REQUIRED	WARM MIX ASPHALT REQUIRED	LENGTH	WIDTH	0106000000-E	1220000000-E	1245000000-E	1297000000-E	1330000000-E	1519000000-E	1575000000-E	1704000000-E	2800000000-N	2830000000-N	2845000000-N	6000000000-E	6071010000-E	
												BORROW EXCAVATION	INCIDENTAL STONE BASE	SHOULDER RECONSTRUCTION	MILLING ASPHALT PAVEMENT, 1 1/2" DEPTH	INCIDENTAL MILLING	SURFACE COURSE, 59.5B	ASPHALT BINDER FOR PLANT MIX	PATCHING EXISTING PAVEMENT	ADI. OF CATCH BASIN	ADI. OF MANHOLES	ADI. OF METER OR VALVE BOX	TEMPORARY SILT FENCE	WATTLE	
												MI	FT	CY	TONS	SMI	SY	SY	TONS	TONS	TONS	EA	EA	EA	LF
2022CPT.09.09.10851	Stokes	1	NC8	FROM ROSEBUD RD SR1945 TO NC89	1	2	ZWD	NO	NO	4.545	23-42	545	250	9.09	67,395	4,876	6,426	431	10				1,818	182	
TOTAL FOR MAP NO. 1												4.545	545	250	9.09	67,395	4,876	6,426	431	10				1,818	182
2022CPT.09.09.10851	Stokes	2	NC66	FORSYTH COUNTY LINE TO FLYNT RD SR1219	2	2	ZWD	NO	NO	6.837	25-28	820	310	13.67		9,061	10,565	708	10	1	1	25	2,735	273	
TOTAL FOR MAP NO. 2												6.837	820	310	13.67		9,061	10,565	708	10	1	1	25	2,735	273
2022CPT.09.09.10851	Stokes	3	NC704	NC89 TO ARRONS CORNER CHURCH RD SR1434	2	2	ZWD	NO	NO	2.443	22	293	66	4.89		2,171	3,056	205	10				977	98	
TOTAL FOR MAP NO. 3												2.443	293	66	4.89		2,171	3,056	205	10				977	98
TOTAL FOR PROJ NO. 2022CPT.09.09.10851												13.825	1,658	626	27.65	67,395	16,108	20,047	1,344	30	1	1	25	5,530	553
2022CPT.09.10.20851	Stokes	4	ASBURY RD SR1413	FROM ASBURY RD SR1432 TO NC89	2	2	ZWD	NO	NO	0.682	22	82	18	1.36		1,117	803	54	10				273	27	
TOTAL FOR MAP NO. 4												0.682	82	18	1.36		1,117	803	54	10				273	27
2022CPT.09.10.20851	Stokes	5	HAWKINS RD SR1973	FROM MOUNTAIN VIEW RD/ N FRIENDSHIP RD SR1955 TO FLATSHOALS RD SR2019	2	2	ZWD	NO	NO	3.409	24-29	409	100	6.82		1,675	4,546	305	10				1,364	136	
TOTAL FOR MAP NO. 5												3.409	409	100	6.82		1,675	4,546	305	10				1,364	136
2022CPT.09.10.20851	Stokes	6	MOUNTAIN RD SR2018	FROM NC8 TO FLAT SHOALS RD SR2019	2	2	ZWD	NO	NO	4.069	21	488	150	8.14		1,613	4,821	323	10				1,628	163	
TOTAL FOR MAP NO. 6												4.069	488	150	8.14		1,613	4,821	323	10				1,628	163
TOTAL FOR PROJ NO. 2022CPT.09.10.20851												8.16	979	268	16.32		4,405	10,170	682	30				3,265	326
GRAND TOTAL												21.985	2,637	894	43.97	67,395	20,513	30,217	2,026	60	1	1	25	8,795	879

Note: All Quantities listed include turn lanes and are estimates; Payment will be based on actual field measurements and quantities received

PROJECT NO.	SHEET NO.	TOTAL NO.
2022CPT.09.09.10851	11	
2022CPT.09.10.20851		

THERMOPLASTIC AND PAINT QUANTITIES

PROJECT NO	COUNTY	MAP NO	ROUTE	DESCRIPTION	TYP NO	LANES	LANE TYPE	LENGTH	WIDTH	4413000000-E	4457000000-N	4685000000-E		4688000000-E		4695000000-E	4710000000-E	4725000000-E		4815000000-E	4895000000-N		
										WORK ZONE ADVANCE/GENERAL WARNING SIGNING	TEMPORARY TRAFFIC CONTROL	4" X 90 M WHITE THERMO	4" X 90 M YELLOW THERMO	6" X 90 M WHITE THERMO	6" X 90 M YELLOW THERMO	8" X 90 M YELLOW THERMO	24" X 90 M WHITE THERMO	THERMO LT ARROW 90 M	THERMO STR ARROW 90 M	6" YELLOW PAINT	NON CAST SNOWPLOWABLE MARKER		
								MI	FT	SF	LS	LF	LF	LF	LF	LF	EA	EA	LF	EA			
2022CPT.09.09.10851	Stokes	1	NC8	FROM ROSEBUD RD SR1945 TO NC89	1	2	2WD	4.545	23-42	510	1			48,904	59,994	252				59,994	325		
TOTAL FOR MAP NO. 1								4.545		510	1			48,904	59,994	252				59,994	325		
2022CPT.09.09.10851	Stokes	2	NC66	FORSYTH COUNTY LINE TO FLYNT RD SR1219	2	2	2WD	6.837	25-28	766				73,776	77,220	316	125	8	4		500		
TOTAL FOR MAP NO. 2								6.837		766				73,776	77,220	316	125	8	4		500		
2022CPT.09.09.10851	Stokes	3	NC704	NC89 TO ARRON'S CORNER CHURCH RD SR1434	2	2	2WD	2.443	22	274				26,287	26,287						165		
TOTAL FOR MAP NO. 3								2.443		274				26,287	26,287							165	
TOTAL FOR PROJ NO. 2022CPT.09.09.10851								13.825		1,550	1			148,967	163,501	568	125	8	4		59,994	990	
											312,468				12								
2022CPT.09.10.20851	Stokes	4	ASBURY RD SR1413	FROM ASBURY RD SR1432 TO NC89	2	2	2WD	0.682	22	77			7,338	7,338									
TOTAL FOR MAP NO. 4								0.682		77			7,338	7,338									
2022CPT.09.10.20851	Stokes	5	HAWKINS RD SR1973	FROM MOUNTAIN VIEW RD/ N FRIENDSHIP RD SR1955 TO FLATSHOALS RD SR2019	2	2	2WD	3.409	24-29	382			36,681	36,681									
TOTAL FOR MAP NO. 5								3.409		382			36,681	36,681									
2022CPT.09.10.20851	Stokes	6	MOUNTAIN RD SR2018	FROM NC8 TO FLAT SHOALS RD SR2019	2	2	2WD	4.069	21	456			43,782	43,782									
TOTAL FOR MAP NO. 6								4.069		456			43,782	43,782									
TOTAL FOR PROJ NO. 2022CPT.09.10.20851								8.16		915			87,801	87,801									
											175,602												
GRAND TOTAL								21.985		2,465	1		87,801	87,801	148,967	163,501	568	125	8	4	59,994	990	
											175,602		312,468				12						

Note: All quantities listed include turn lanes and are estimates; Payment will be based on actual field measurements and quantities received